

# Inquiry form for roof plants

## Customer information:

Date: \_\_\_\_\_

### Client:

Company stamp

Company: \_\_\_\_\_  
 Contact person: \_\_\_\_\_  
 Street/ House no.: \_\_\_\_\_  
 Postal code: \_\_\_\_\_  
 City: \_\_\_\_\_  
 Country: \_\_\_\_\_  
 Contact person Tel.: \_\_\_\_\_  
 e-mail: \_\_\_\_\_

### Location of construction site:

Country: \_\_\_\_\_  
 Region: \_\_\_\_\_  
 County: \_\_\_\_\_  
 Postal code: \_\_\_\_\_  
 City: \_\_\_\_\_  
 Street / House no.: \_\_\_\_\_

height above sea level: \_\_\_\_\_

Snow load: \_\_\_\_\_ kN/m<sup>2</sup> / wind speed: \_\_\_\_\_ m/s

## Roof information:



Gabled roof



Hipped roof



Half-hipped roof



Pavilion roof



Single pitch roof



Flat roof

Ridge length a (mm): \_\_\_\_\_

Roof width b (mm): \_\_\_\_\_

Ridge height h (mm): \_\_\_\_\_

Roof pitch  $\alpha$  (°): \_\_\_\_\_

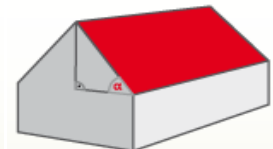
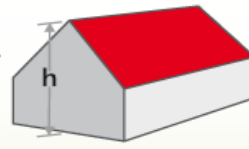
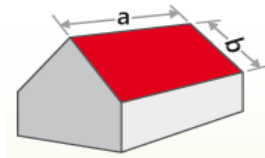

Roof penetration permitted?  yes  no

Roof covering:

- |   |   |
|---|---|
| <input type="checkbox"/> Tiles                          | <input type="checkbox"/> Plain tile                 |
| <input type="checkbox"/> Slate                          | <input type="checkbox"/> Trapezoidal/Sandwich sheet |
| <input type="checkbox"/> Corrugated metal               | <input type="checkbox"/> Standing seam metal        |
| <input type="checkbox"/> Kalzip                         | <input type="checkbox"/> Zambelli                   |
| <input type="checkbox"/> Foil                           | <input type="checkbox"/> Bitumen                    |
| <input type="checkbox"/> Paper                          | <input type="checkbox"/> Concrete                   |
| <input type="checkbox"/> Others (please describe) _____ |   |

Roof construction:



Rafters  wood  steel  
 Distance between rafters \_\_\_\_\_ mm  
 Rafter height \_\_\_\_\_ mm  
 Rafter width \_\_\_\_\_ mm

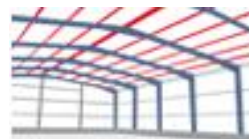

Beams  wood  steel  
 Distance between beams \_\_\_\_\_ mm  
 Beam height \_\_\_\_\_ mm  
 Beam width \_\_\_\_\_ mm

**Mounting system:**

\_\_\_\_\_ rows with \_\_\_\_\_ modules

Heading:

 vertically mounted horizontally mounted

Layers:

 Single layer Double layer (cross mounting)

Tilt of the modules, if flat roof system (°): \_\_\_\_\_

**Module information:**

Module dimensions:

\_\_\_\_\_ X \_\_\_\_\_ X \_\_\_\_\_ mm

Module power:

\_\_\_\_\_ Wp

Module quantity:

\_\_\_\_\_ pcs

Total power of the plant: \_\_\_\_\_ kWp

**Attachments:***All additional information is helpful to calculate the correct items and correct quantities.* Modules arrangement plan Roofpictures (inside and outside) Data sheet of modules Data sheet of roof covering**Contact:***Please send the completed form to the contacts listed below.*

E-Mail:

[u.dikmen@oberhauser-pv.de](mailto:u.dikmen@oberhauser-pv.de)

Fax:

+49 8635 69392 - 20

*In case of questions please don't hesitate to contact us.*

Address:

Oberhauser Bau-Systeme GmbH; Rohrbach-Bahnhof 18; 84494 Niederbergkirchen

Tel:

+49 8635 69392 - 11

Homepage:

[www.oberhauser-pv.de](http://www.oberhauser-pv.de)